



Scope of Work

Main Wharf Eastern Entrance:

- New tourism building at the main wharf eastern gate for cruise ship visitors and port security staff.
- Refurbishment and reinstatement of existing port gates.
- Footpaths and pedestrian crossing inside the port gates to improve safety.
- Landscaping, seating and lighting improvements.

Progress Update

Phase 1 – Tourism Building:

- Commenced work on the 16-meter retaining wall.
- Works for the tourism building are currently under review due to the location of underground services.

Works Expected This Month

Phase 1 – Tourism Building:

- Repairs to the existing port gates continuing.
- Tourism Building pre-cast concrete wall panels underway.

Traffic Management

- Traffic management at the main wharf by everyone will be critical to avoid congestion, particularly on cruise ship days. **Please adhere to all instructions from police and port security staff.**
- Heavy vehicle movements will be scheduled on non-cruise ship days to minimise disruption.
- A 60-day trial Traffic Management Plan by GoV is proposed to improve vehicle movements on cruise ship days. Expected to commence this month following approval from relevant ministers.

Public Health & Safety

- Site security fencing has been erected for public safety. Construction works will be carried out within the fenced area. Large deliveries to site will be scheduled outside of peak hours.
- Access to the main wharf will be maintained at all times.
- Width of the existing access to the port has been reduced to provide sufficient working area for Hawkins

Contractor – Key Contact

Hawkins Infrastructure Ltd, Pacifica Building, Rue de Paris.
Project Engineer – Susan Temple (s.temple@hawkins.co.nz)



Scope of Work

Chantilly's to Anchor Inn:

- Upgrade to Fatumaru Bay Park open spaces and provide access to the water.
- Upgrade landscaping, lighting, furniture and playground.
- Protect the coastal edge with a rock revetment to minimise erosion.
- Resurfacing carpark opposite TVL House.
- Improved drainage through the park.

Progress Update

Phase 1 – Near Chantilly's:

- Coastal protection rock revetment completed in the 40-meter section from Chantilly's.
- First rock pool complete.
- Footpath widening along the length of Fatumaru Bay Park underway. Concrete poured in Phase 2.
- Foundation for sea access steps commenced.
- Fatumaru Bay Park children's playground demolished. A new playground will be built as part of the works.

Works Expected This Month

Phase 1 – Near Chantilly's:

- Phase 1 almost complete, rolling into Phase 2 with site clearance and debris removal.
- Security site fencing installed and site access adjusted for Phase 2 works.
- Sea access steps to be poured.
- Extension of current footpath to Chantilly's.
- Continuation of rock deliveries and placement of rock revetment for Phase 2 works.

Night Works

- The scope of the work includes some seabed excavation to anchor the toe of the rock revetment. Consequently, the contractor (Hawkins) is having to work around the low tides, and sometimes this may mean working late into the evening. We apologise in advance for any inconvenience.

Public Health & Safety

- Please use designated pedestrian routes between the orange temporary fences. These are for your own safety.
- Additional safety fencing has been erected in the park around the street light ducts. Please avoid these areas.
- If you require access to the site for any reason you must contact the Contractor in the first instance to arrange a Safety briefing beforehand. See contact details below.

Contractor – Key Contact

Hawkins Infrastructure Ltd, Pacifica Building, Rue de Paris.
Project Engineer – Susan Temple (s.temple@hawkins.co.nz)

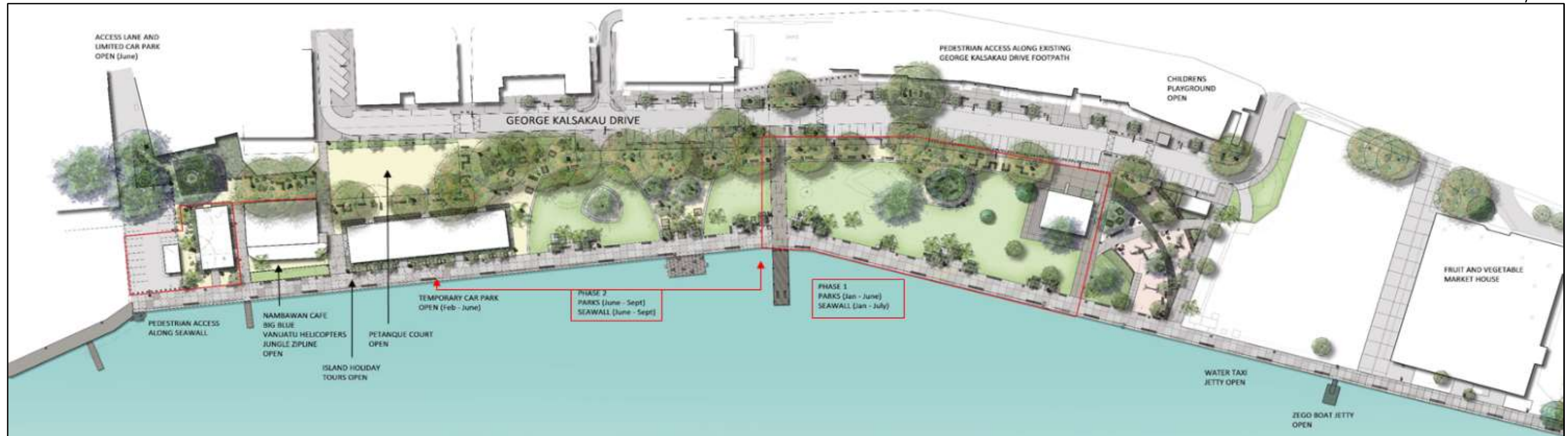

Progress Update

Seafont Park (Near Nambawan Café):

- Site marked out for the small market house and new public toilet.
- Timber decking almost complete.
- Landscaping coral chip laid behind Nambawan Café building.
- Park bench (seats) and landscape screen footings complete.
- Car park (Healthwise to the Sea wall) excavation complete.
- Foundation work for carpark kerbing underway.
- Formwork and reinforcement for foundation slab for the new public toilet complete.

Works Expected This Month

Phase 3a – Near Nambawan Café:

- Car Park concrete pavement is poured.
- Pour the concrete slab for the public toilets.
- Prepare to re-open parts of the site for public access.
- Mould for the toilet pre-cast walls ready for inspection.

George Kalsakau Drive

- George Kalsakau Drive (GKD) is being upgraded under a separate project: the Port Vila Urban Development Project (PVUDP). This is not part of the Vanuatu Tourism Infrastructure Project (VTIP).
- For enquiries contact CCEDD Ltd by email: contact @PVUDP.com.

Contractor – Key Contact :

Hawkins Infrastructure Ltd, Pacifica Building, Rue de Paris. Project Engineer – Susan Temple (s.temple@hawkins.co.nz)



Piling rig to be used at the sea front

Noisy Works

A barge carrying a piling crane will be used to install the sheet piles for the new central pier and the sea steps at the sea front. This will be noisy work as the vibro hammer clamps onto the top of the sheet pile one at a time to vibrate it into position. All works will be done from the barge with a crew of 10 men. A start date for these works is yet to be confirmed.

Public Information Day

With multiple construction projects in progress at the Seafont Park, Fatumaru Bay Park and Wharf Road there is a lot of interest from the public about the progress of works to date and the outlook for the end of the works so a Public Information Day will be held on **Friday 20th May 2016**. Information will be presented by Hawkins International Ltd who are undertaking all the construction works. Beca International Ltd will be available to answer any technical questions.

- The Public Information Day will be held on **Friday 20th May** commencing at 9.30am with an opening by the Government of Vanuatu. The event will be hosted at Jungle Zipline office behind Nambawan Café.

Progress Update

Seafont Park (Near Seafont Stage):

- Pre-casting of concrete panels for the sea wall is progressing.
- Founding concrete laid for work platform in preparation for pouring concrete inside the sea wall.
- Plugging of holes; reinforcement of exposed steel sheet piles and approximately 30 meters of concrete poured on the landside of the seawall.
- Stage ramp walls poured; some remedial works underway.
- Stage stairs foundations, columns and beams complete.
- Park works near the stage commenced with mound steps poured.
- UNELCO have installed new service connections (power) into the seafont park.

Works Expected This Month

Phase 1 – Near Seafont Stage:

- Continuing inspection and review of precast concrete panels for the sea wall during manufacture.
- Commence installation of the precast panels for the sea wall.
- Continue to pour in-situ concrete in Phase 1 of the seawall.
- Pour concrete for the Seafont Stage access steps.
- Excavation behind the seawall and removal of the sea wall capping beam continues into Phase 2.